



2000sf Speed Queen
Coin Example

Distributor:

Alliance Laundry Systems LLC
119 Shepard Street
Ripon, WI 54971
PH: 920-748-3121
Fax: 920-748-4456

Project No. C13----

Drawn By: ESZ

Dwg. No. C-----

Date 11-Mar-13

This drawing is not intended for construction purposes. Equipment specifications are subject to change without notice.
Alliance Laundry Systems LLC shall not be responsible for any changes made to any of its layouts and/or installation specifications without its prior written approval.

Sheet 1 of 1

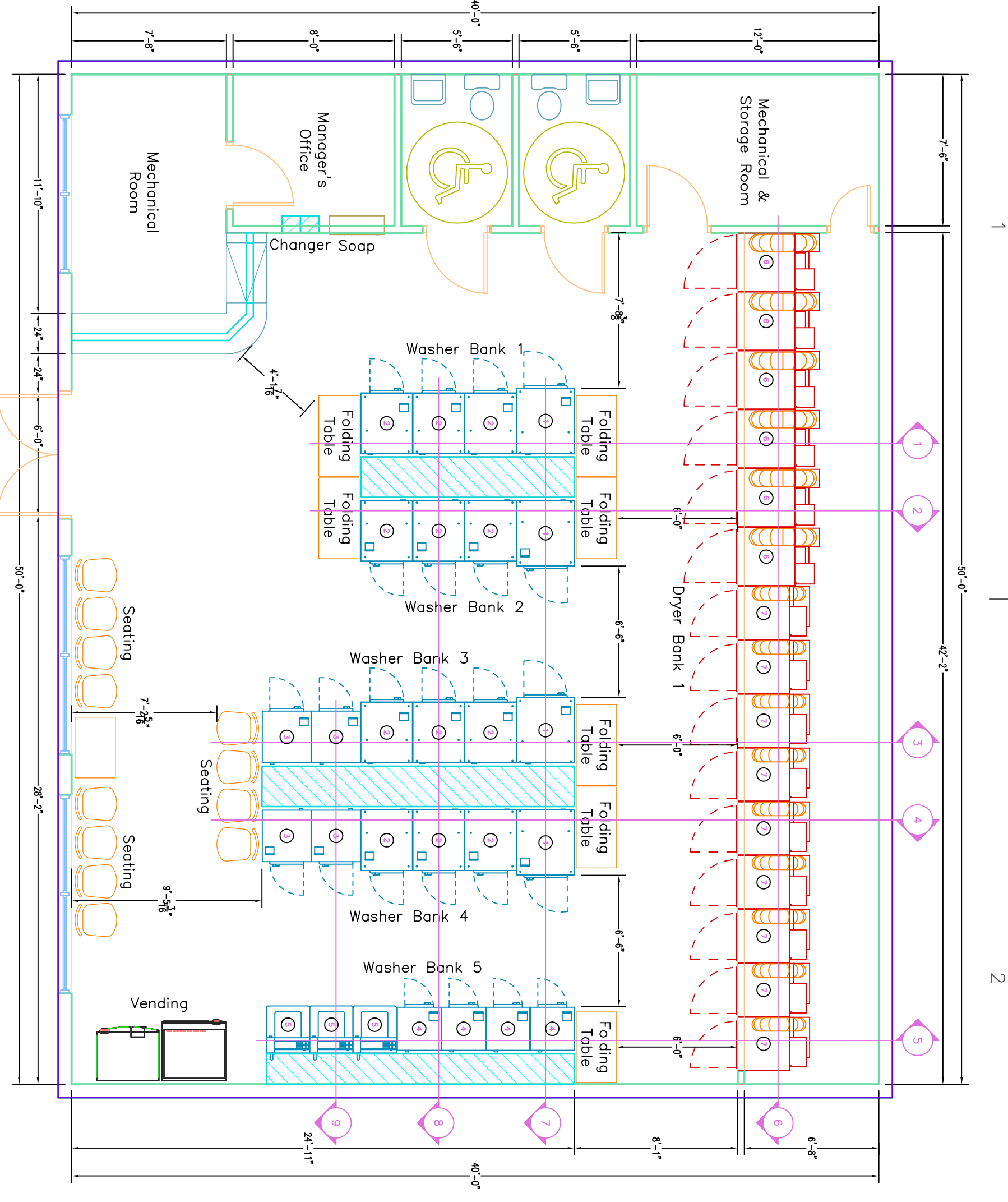

EQUIPMENT LIST

ITEM	MANUFACTURER	MODEL	DESCRIPTION	QTY	FINISH
1	SPEED QUEEN	SON060WCF	WASHER-EXTRACTOR	4	
2	SPEED QUEEN	SON040WCF	WASHER-EXTRACTOR	12	
3	SPEED QUEEN	SON030WCF	WASHER-EXTRACTOR	4	
4	SPEED QUEEN	SON020WCF	WASHER-EXTRACTOR	4	
5	SPEED QUEEN	SWT121	TOPLOAD WASHER	3	
6	SPEED QUEEN	STT45N	STACK TUMBLER	6	
7	SPEED QUEEN	STT33N	STACK TUMBLER	9	
8	SPEED QUEEN	ACBF60X6X1	SC40 SINGLE BASE	4	
9	SPEED QUEEN	ACBF40X6X3	SC40 TRIPLE BASE	4	
10	SPEED QUEEN	ACBF30X6X2	SC30 DOUBLE BASE	2	
11	SPEED QUEEN	ACBF20X6X2	SC20 DOUBLE BASE	2	

ELECTRICAL REQUIREMENTS

MODEL	VOLTAGE	FULL LOAD AMP DRAW	DESIRED BREAKER	WIRE SIZE
SON060WCF	208-240/60/3ø	6A	15A	AWG14
SON040WCF	208-240/60/3ø	4A	15A	AWG14
SON030WCF	208-240/60/3ø	4A	15A	AWG14
SON020WCF	208-240/60/3ø	3A	15A	AWG14
SWT121	110-120/60/1ø	9.8A	15A	AWG14
STT45N	208-240/60/1ø	1.2A	15A	AWG14
STT33N	110-120/60/1ø	1.6A	20A	AWG12
TOTALS	N/A	34.3A	67.5A	N/A

ALL MACHINES MUST BE GROUNDING. PROVIDE GROUND SOURCE IN ACCORDANCE WITH CODES.
CONSULT ELECTRICAL CODE FOR LOCAL REQUIREMENTS. USE ONLY 3 POLE CIRCUIT BREAKERS FOR 3ø SERVICE. MANUFACTURERS RECOMMEND PROVIDING 1 CIRCUIT BREAKER FOR EACH MACHINE.
FOR SAFETY PURPOSES, CLEARLY MARKED & EASILY ACCESSIBLE POWER CUTOFF SWITCHES CAN BE PROVIDED FOR EACH MACHINE.

DRAIN REQUIREMENTS

MODEL	REQUIRED MIN. DRAIN LINE FROM MACHINE	REQUIRED MIN. DRAIN LINE FOR EACH BULKHEAD
SON060WCF	3"	4"
SON040WCF	3"	
SON030WCF	2"	
SON020WCF	2"	
SWT121	1 1/2"	

DRAIN MUST BE VENTED.
CONSULT PLUMBING CODES FOR LOCAL REQUIREMENTS.

GAS REQUIREMENTS

MODEL	OPERATING PRESSURE	GAS TYPE	MAX INPUT BTU/HOUR	CONNECTION SIZE	RECOMMENDED SUPPLY LINE
STT45N	6.5"±1.5"	NATURAL	190000	1/2"	3"
STT33N	6.5"±1.5"	NATURAL	148000	1/2"	3"
TOTAL			2454000		

PROVIDE 1" LOOP TO EQUALIZE GAS PRESSURE.
GAS CONNECTION TO BE PERFORMED BY QUALIFIED TECHNICIAN IN ACCORDANCE WITH LOCAL CODES.

DYNAMIC LOAD SPECIFICATIONS

MODEL	STATIC LOAD(LBS)/SF	DYNAMIC LOAD (LBS)/SF	MAXIMUM DYNAMIC LOAD(LBS)/SF	DYNAMIC LOAD RECOVERY HR
SON060WCF	106	14.3	14.3	8.1
SON040WCF	100	119	119	8.6
SON030WCF	99	109	109	9.0
SON020WCF	96	96	96	9.7

* DYNAMIC LOAD FREQUENCY AT HIGHEST FACTORY-PRESET EXTRACT SPEED.

EXHAUST/VENT REQUIREMENTS

MODEL	SIZE	AIR FLOW	MIN. CROSS SECT. AREA ALL MACHINES
STT45N	10"	1200 cfm	6x98 sq in
STT33N	8"	800 cfm	9x63 sq in

PROVIDE AT LEAST 25.8 SQ FT OPEN AREA FOR ALL DRYER MAKE-UP AIR SUPPLY. THIS FIGURE DOES NOT INCLUDE MAKE-UP AIR PROVISIONS FOR FINISHERS IF APPLICABLE.

WATER REQUIREMENTS

MODEL	COLD WATER		HOT WATER		AVERAGE HOT WATER DEMAND IN GALLONS/24 HRS	MAXIMUM WAVE FLOW IN GALLONS/MINUTE	RECOMMENDED LINE SIZE TO SUPPLY ALL MACHINES		RECOMMENDED LINE SIZE TO SUPPLY ALL MACHINES	
	CONNECTION SIZE	PRESSURE MIN. / MAX.	CONNECTION SIZE	PRESSURE MIN. / MAX.			COLD	HOT	COLD	HOT
SON060WCF	3/4NH	30lbs / 85lbs	3/4NH	30lbs / 85lbs	14.2	10	10	3/4"	3/4"	3/4"
SON040WCF	3/4NH	30lbs / 85lbs	3/4NH	30lbs / 85lbs	9.7	10	10	3/4"	3/4"	3/4"
SON030WCF	3/4NH	30lbs / 85lbs	3/4NH	30lbs / 85lbs	6.5	10	10	3/4"	3/4"	3/4"
SON020WCF	3/4NH	30lbs / 85lbs	3/4NH	30lbs / 85lbs	4.6	10	10	3/4"	3/4"	3/4"
SWT121	3/4NH	20lbs / 120lbs	3/4NH	20lbs / 120lbs	2.99	7	7	1/2"	1/2"	2"

HOT WATER USAGE FIGURES ARE ESTIMATES. ACTUAL CONSUMPTION WILL VARY DEPENDING ON LOCAL CONDITIONS. NUMBER OF CYCLES AND CYCLE TIMES SELECTED, LOAD SIZES AND MATERIALS PROCESSED.

FOR SAFETY PURPOSES, CLEARLY MARKED & EASILY ACCESSIBLE POWER CUTOFF SWITCHES CAN BE PROVIDED FOR EACH MACHINE.

FOR SAFETY PURPOSES, CLEARLY MARKED & EASILY ACCESSIBLE POWER CUTOFF SWITCHES CAN BE PROVIDED FOR EACH MACHINE.

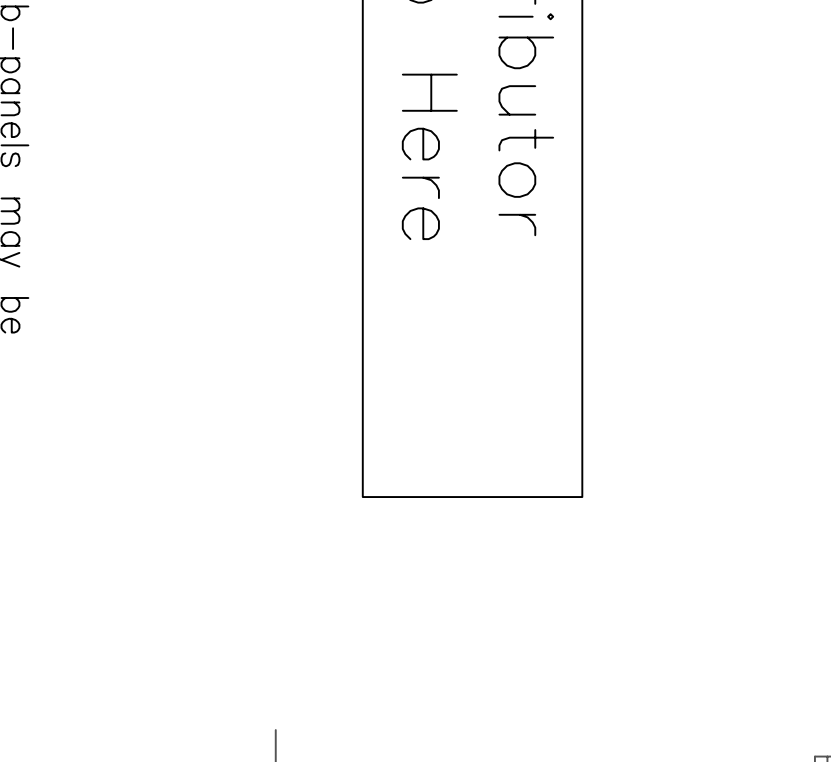
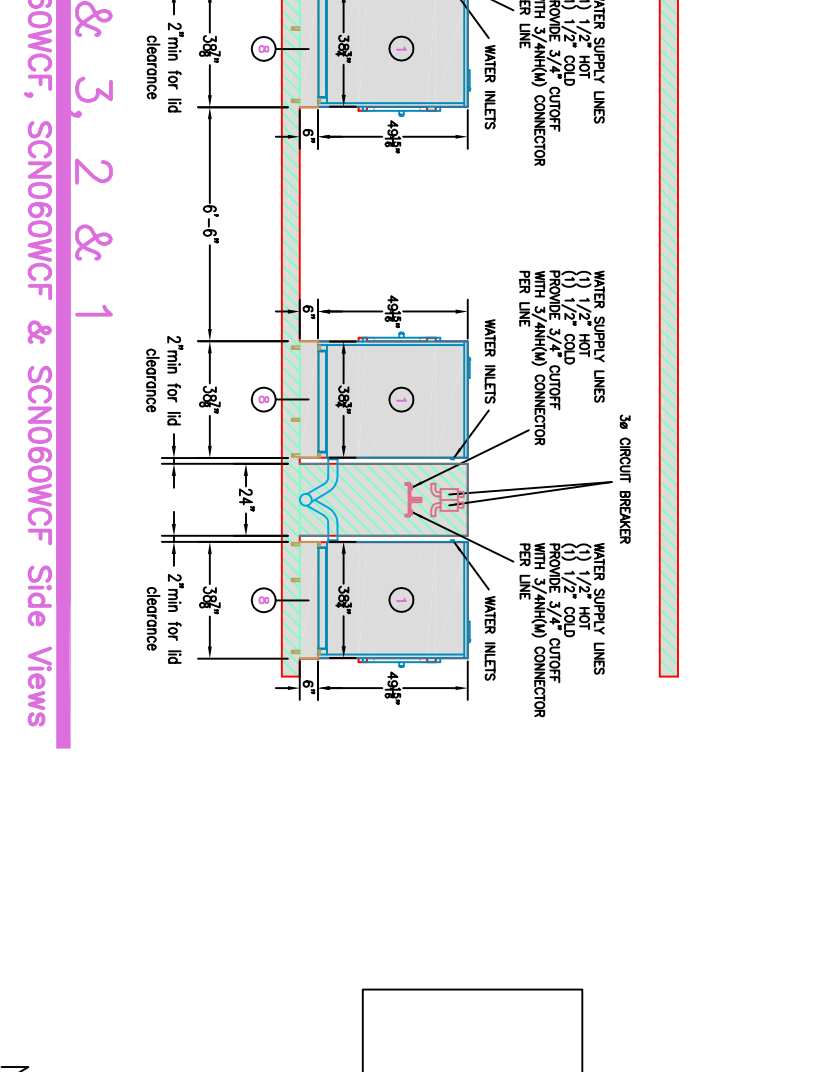
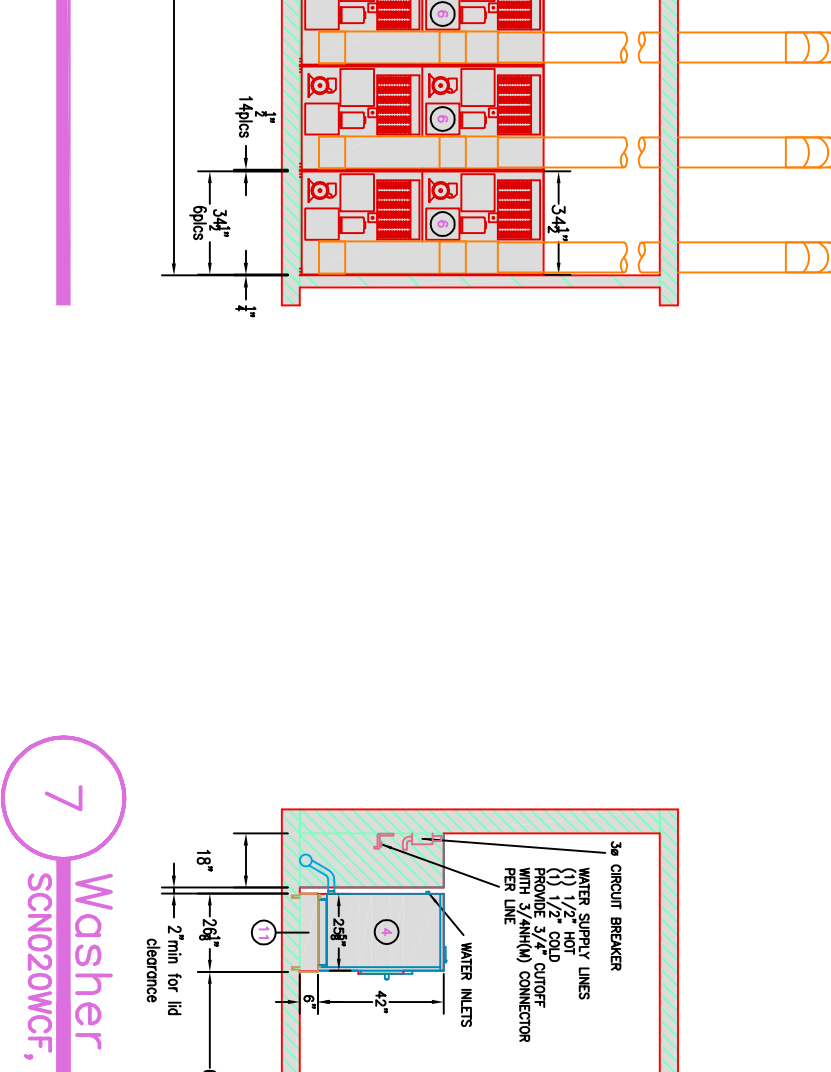
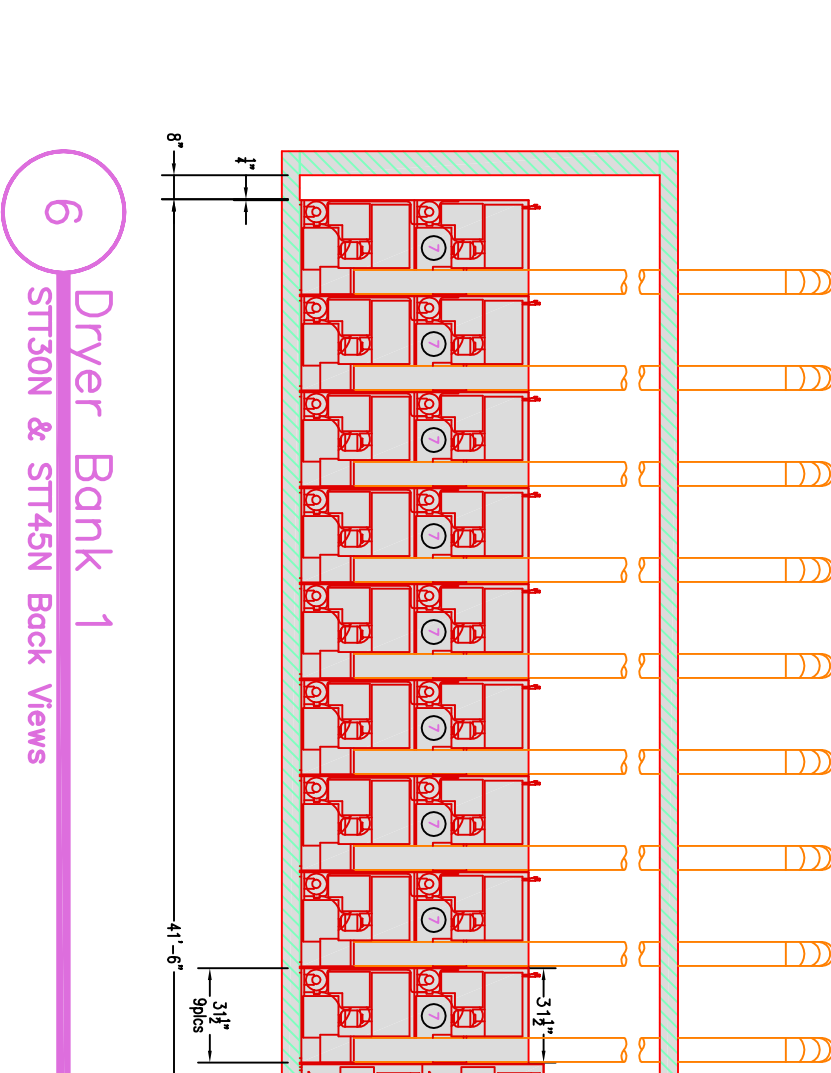
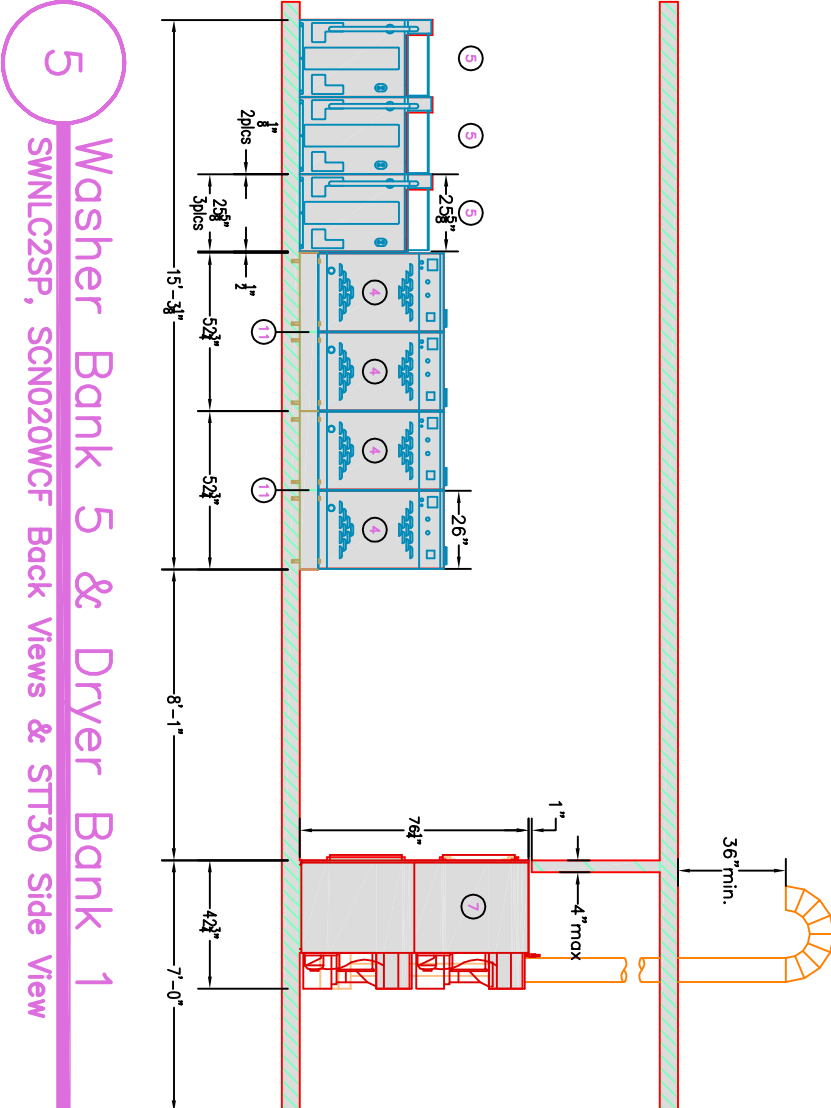
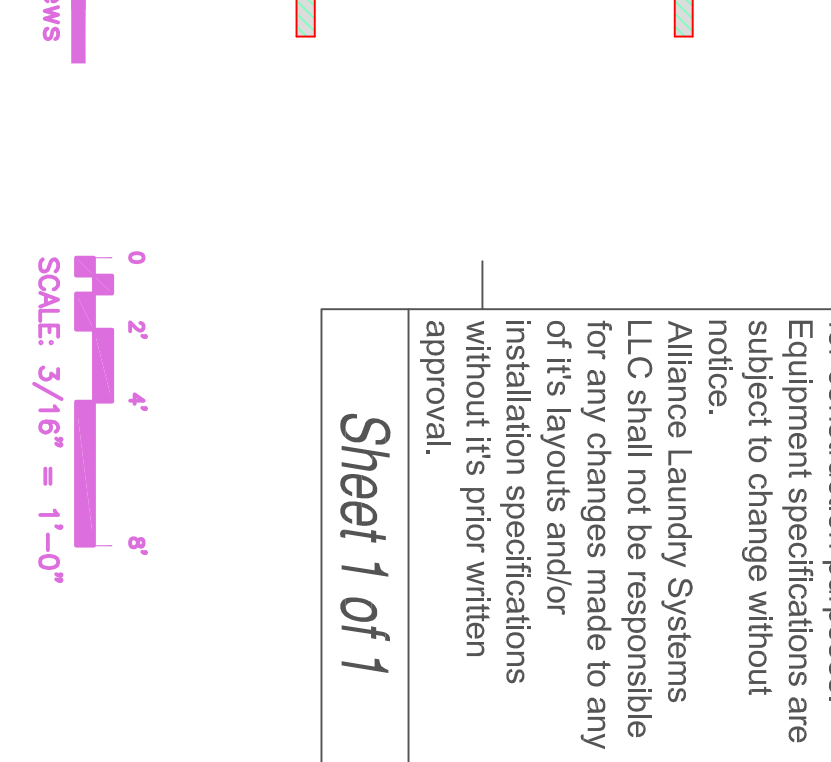
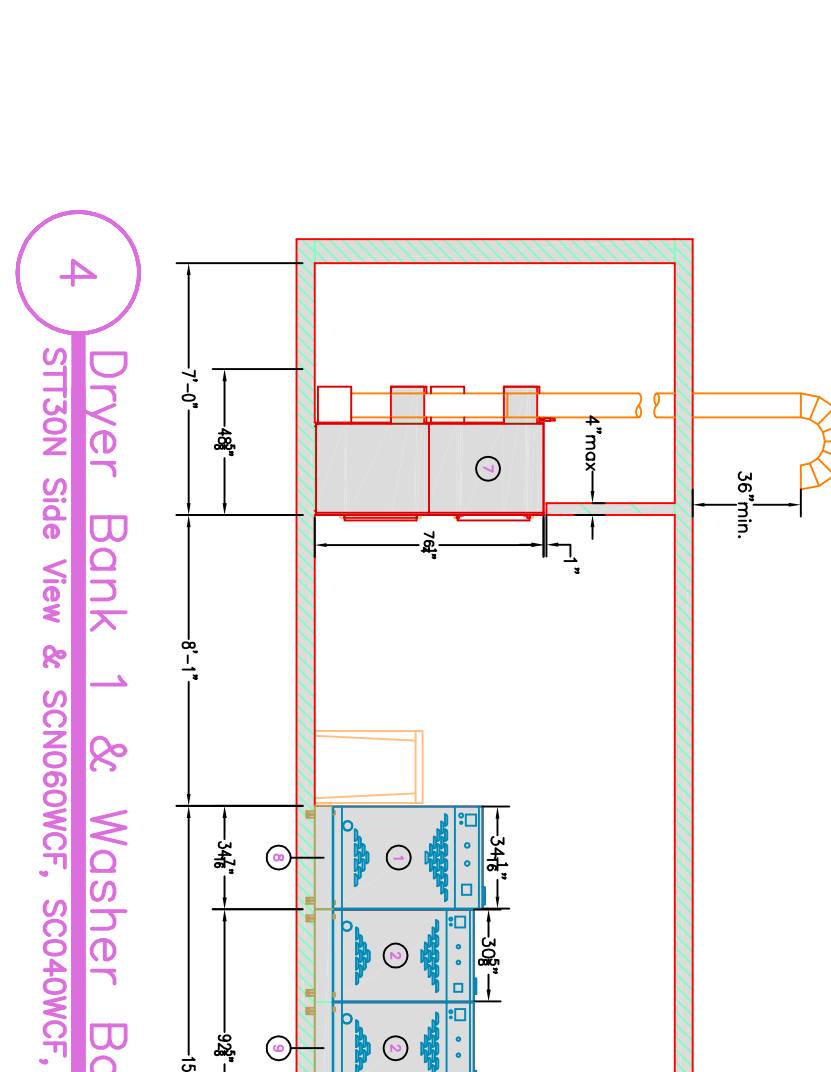
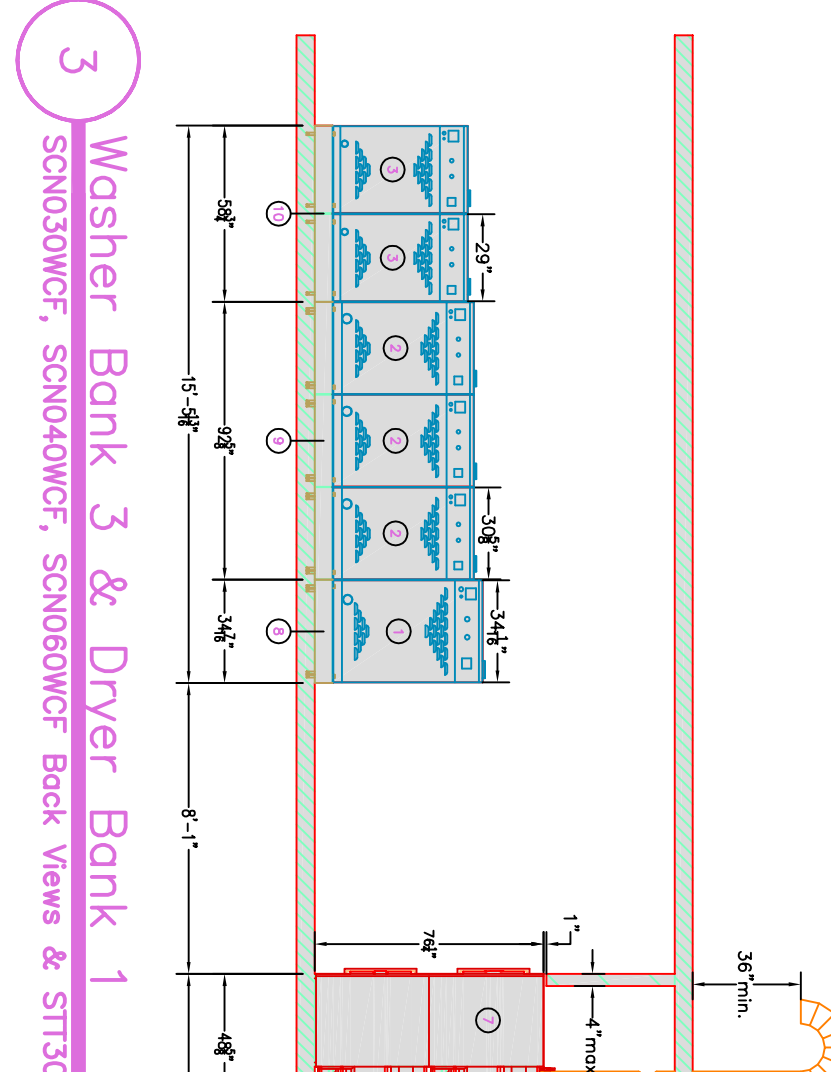
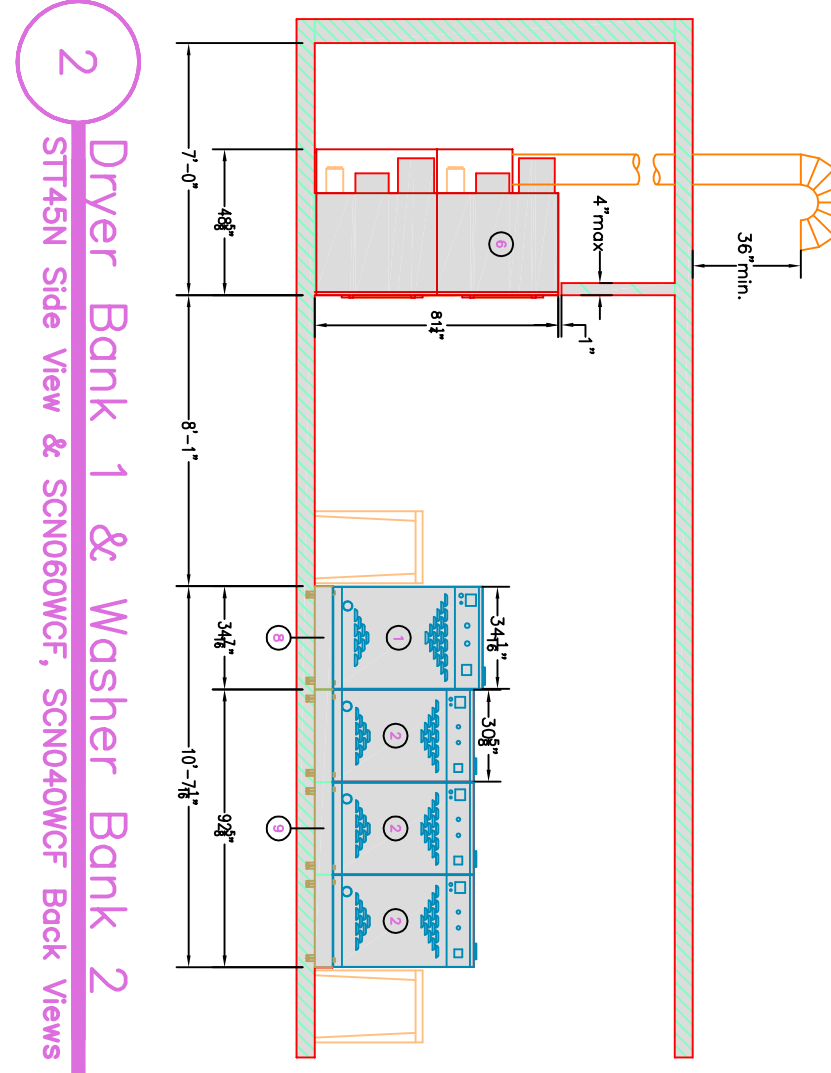
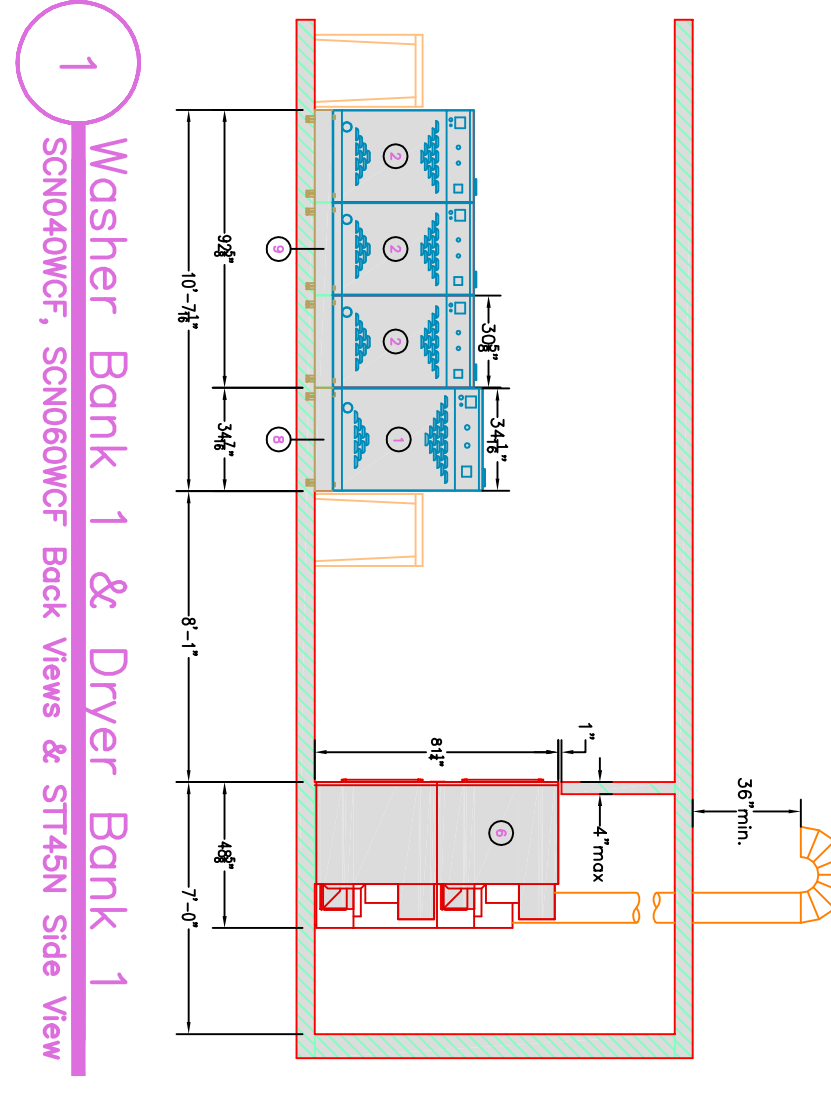
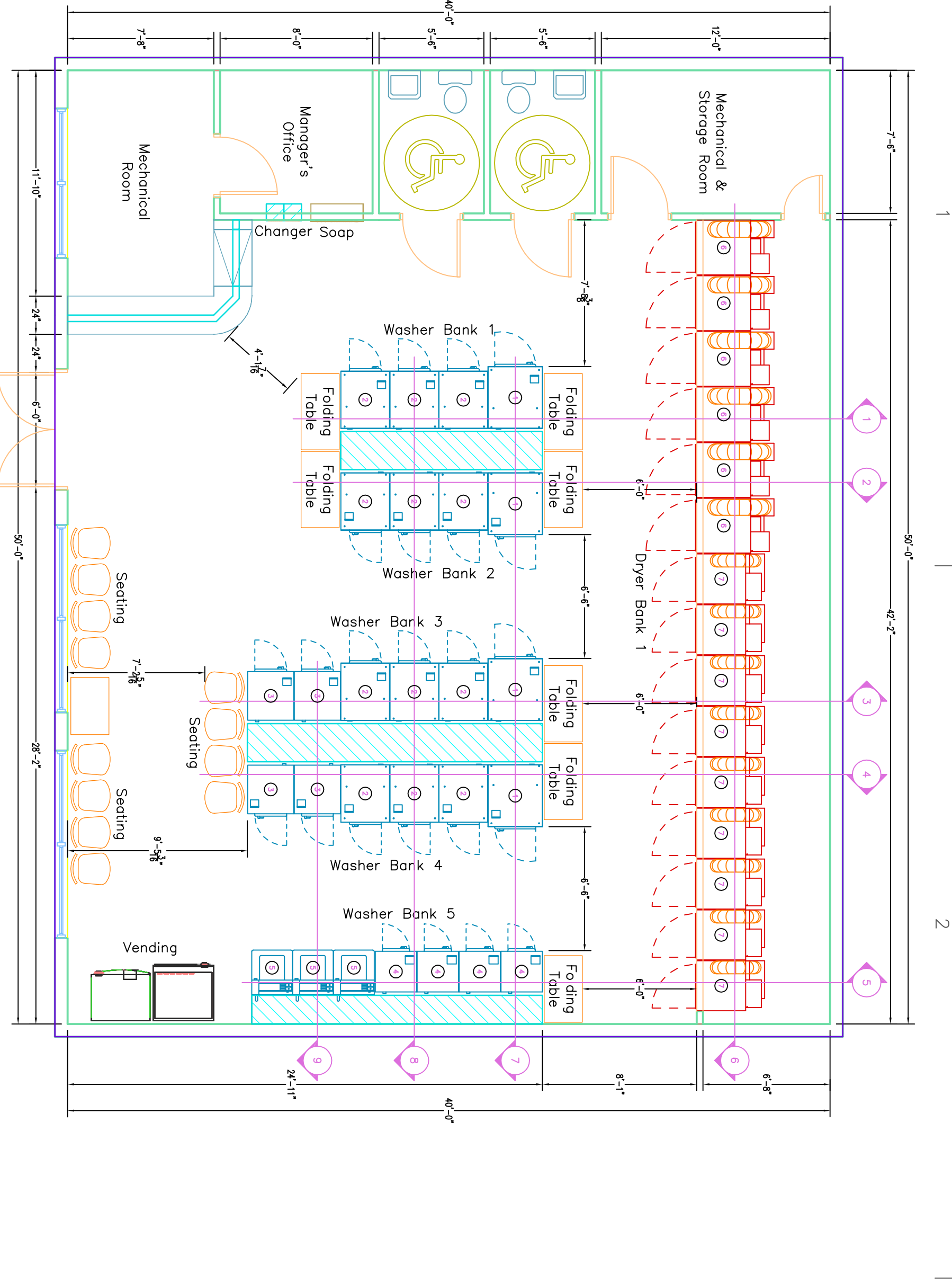

NOTE: All non-Alliance equipment is shown for general placement only. For actual installation requirements please refer to the actual manufacturers installation manual.

Suggested dryer venting arrangement. Consult dryer technical manuals for detailed information. Provide at least 30.0 sq ft unrestricted open area for dryer make-up air supply.

NOTE: Electrical sub-panels may be installed in the bulkheads behind the washers. Please contact the project distributor for further information.

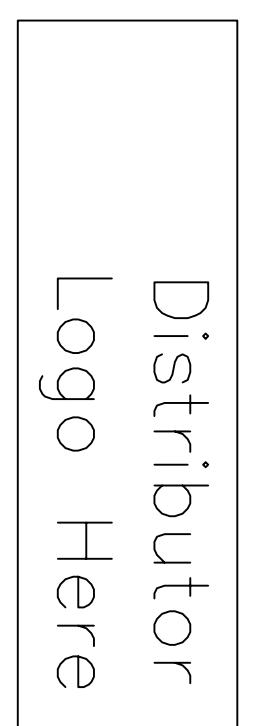

Speed Queen®

For safety purposes, readily accessible emergency stop switch(es) can be provided to remove power to all frontload washers.